

BT9533

NO.	DESCRIPTION
1	CONNECTING DISC ASSEMBLY
2	HARNESS ASSY
3	HARNESS CLAMP
4	CLAMP
5	LEVER ASSY
6	HANDLE
7	CAP UPPER
8	BRACKER
9	CAP LOWER
10	ALUMINIUM PIPE
11	CONNECT PLATE
12	GEARBOX ASSY
13	BLADE
14	LINE PACK
15	GUARD
16	SMALL BLADE
17	STRAIGHT SHAFT
18	BUSH
19	SCREW M6X20
20	SCREW M6X25
21	SCREW M5X14
22	SCREW ST4.2X14
23	SCREW M5X25
24	SCREW M5X25
25	SCREW M6X25

BT9533-EX-PS-ST22001

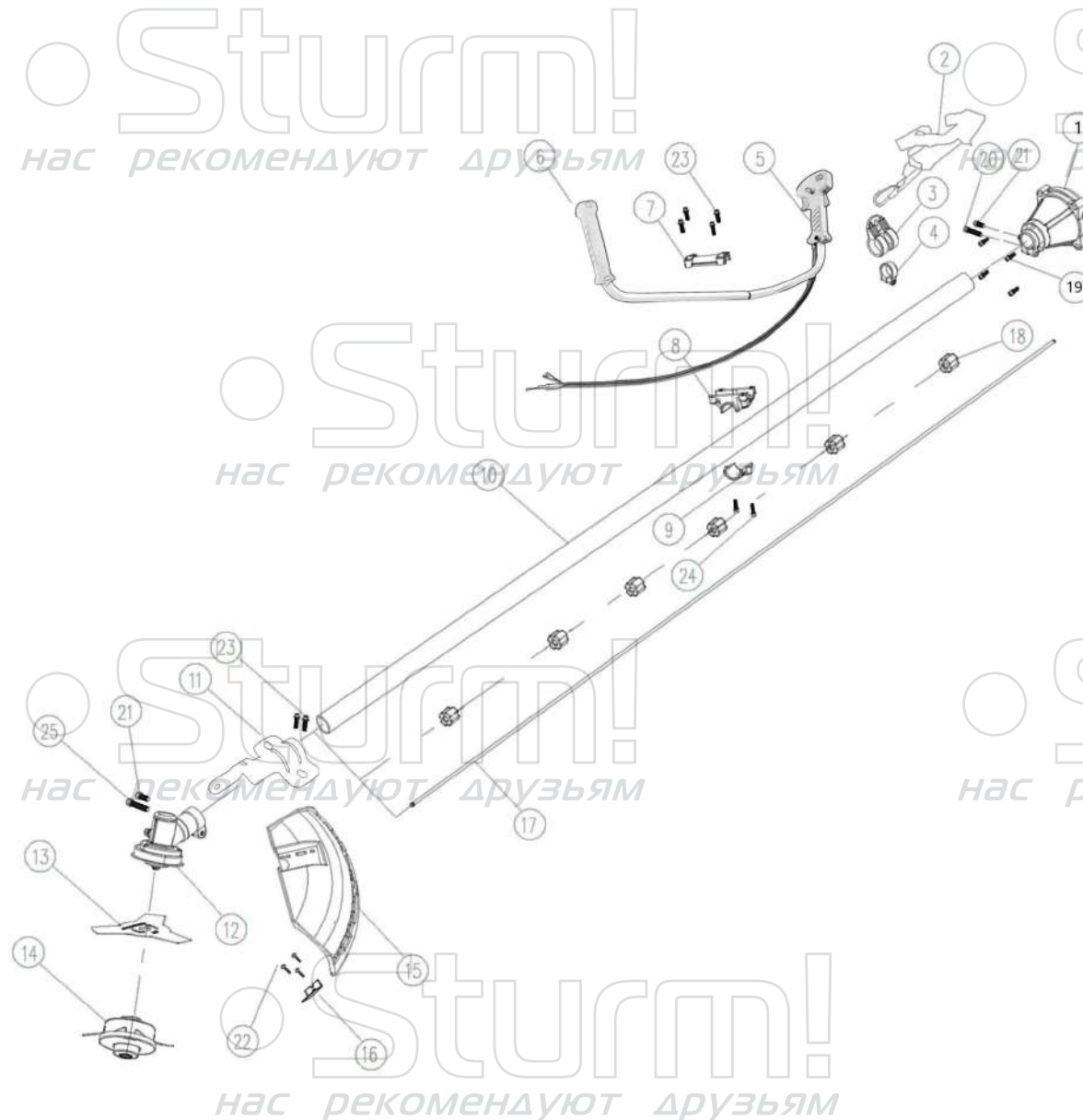

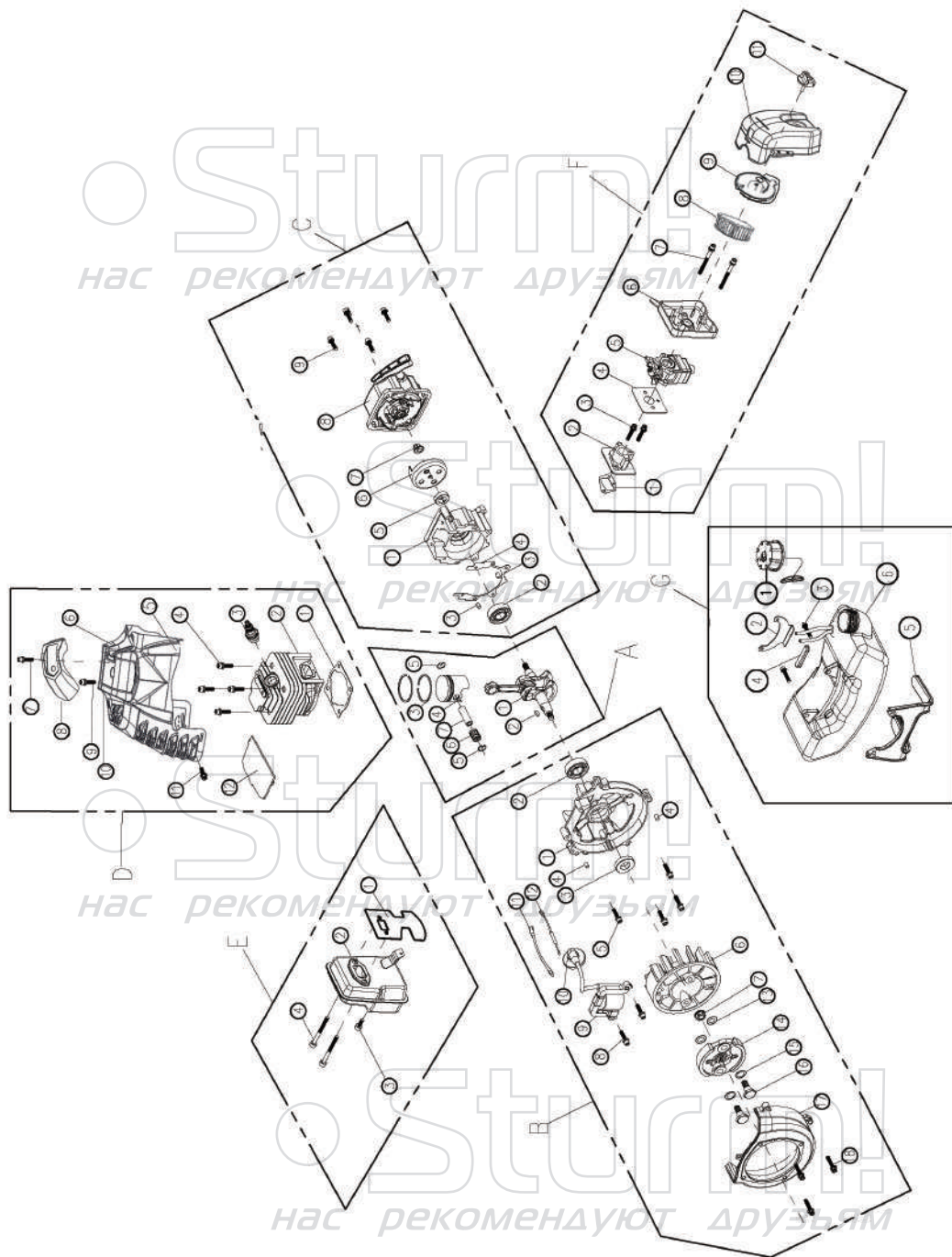

ENGINE FOR BT9533

NO.	DESCRIPTION	NO.	DESCRIPTION
A-1	CRANKSHAFT ASSY	D-1	GASKET
A-2	KEY	D-2	CYLINDER
A-3	PISTON RING	D-3	SPARK PLUG
A-4	PISTON	D-4	SCREW
A-5	PISTON PIN RING	D-5	SCREW
A-6	BEARING	D-6	ENGINE COVER
A-7	PISTON	D-7	SCREW
B-1	CRANKSHAFT CASE	D-8	TOP COVER
B-2	BEARING	D-9	SCREW
B-3	OIL SEAL	D-10	SHIM
B-4	PIN	D-11	SCREW
B-5	SCREW	D-12	WIND SCREEN
B-6	FLYING WHEEL	E-1	GASKET
B-7	NUT	E-2	MUFFLER
B-8	SCREW	E-3	SCREW
B-9	COIL	E-4	SCREW
B-10	SPARK PLUG CAP	F-1	GASKET
B-11	OFF LINE	F-2	INLET PIPE
B-12	OFF LINE	F-3	SCREW
B-13	SHIM	F-4	GASKET
B-14	CLUTCH ASSY	F-5	CARBURETOR
B-15	SHIM	F-6	CARBURETOR HOLDER
B-16	SCREW	F-7	SCREW
B-17	SIDE COVER	F-8	SPONGE
B-18	SCREW	F-9	SPONGE COVER
C-1	CRANKSHAFT CASE	F-10	AIR FILTER COVER
C-2	BEARING	F-11	NUT
C-3	PIN	G-1	TANK CAP
C-4	GASKET	G-2	TANK HOLDER
C-5	OIL SEAL	G-3	SCREW
C-6	DRIVING PLATE	G-4	DAMPING
C-7	NUT	G-5	TANK PROTECTOR
C-8	STARTER ASSY	G-6	TANK
C-9	SCREW		

BT9533-EX-PS-ST22001